

Minimum height added to wellhead
Wellhead – valves, fittings, remain unchanged
Reduce service costs to seal and drive
Increased safety during removal

INSTALLATION PROCEDURE

- POSITION CLAMP BETWEEN STUFFING BOX AND FLOW-TEE
- INSTALL SURFACE DRIVE
- TIGHTEN STUD BOLTS IN A STAR PATTERN AS NORMAL

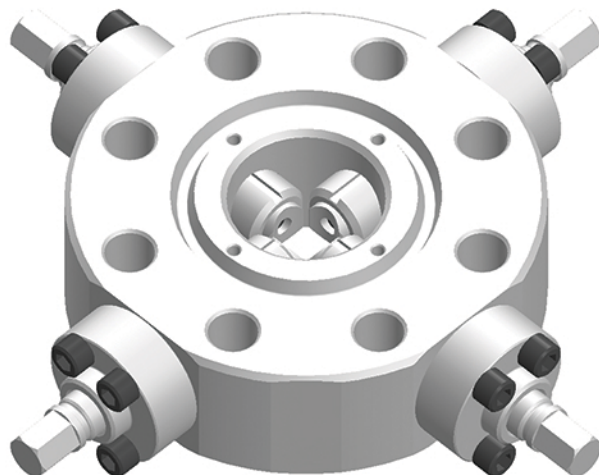

*NOTE: Stud length may need to be lengthened to ensure that there is enough thread exposed to screw on the nut.
 (Approximately 7" x 7/8" for composite flow-tee,
 8 1/2" x 7/8" regular flange connection)*

POLISHROD LOCK OUT

- **SCREW IN ALL STEMS EQUALLY**
 MEASURE HOW FAR EACH STEM STICKS OUT
 TO ENSURE THEY ARE EQUALLY SCREWED IN
- **APPLY 350 FT/LBS AT EACH STEM –**
MAXIMUM HOLDING CAPACITY WILL BE 10 TONS
- **3 1/8 3000 R31/1.25PR**

**THE MANTL PR-LOCK IS A VITAL
 ACCESSORY THAT CAN SUPPORT
 AXIAL ROD WEIGHT DURING
 MAINTENANCE SHUTDOWNS**

TO ENGAGE THE PR-LOCK

- Slowly release the weight of the rods on to the Support Clamp checking for any slippage of the polished rod.
- The support clamp relies on friction between the inserts and polished rod. If the polished slips when the inserts are engaged, it may cause damage, reducing the holding strength.
- The support clamps or plate should be returned to MANTL for service.

TO DISENGAGE THE PR-LOCK

- Support weight of the rods either with the surface drive clamp on the drivehead, flushby or service rig.
- Slowly release torque by unscrewing the stems.
- Back out until the stems reach resistance.

'CAUSE WE GIVE A S#!T